



Laton Road, Hastings TN34 2ES

Offers in excess of £160,000



A beautifully presented ONE BEDROOM GROUND FLOOR APARTMENT with OFF ROAD PARKING and an area of PRIVATE GARDEN. It's located in a quiet tree-lined road offering good transport links, just meters from Alexandra Park, St. Helens Woods and within walking distance of Hastings Town centre where there is a mainline railway station and the beach. Ore railway station is also within walking distance. The accommodation spans the ground floor of this attractive residence and is TASTEFULLY DECORATED WITH A NEUTRAL PALETTE throughout, it enjoys a GRAND, OPEN PLAN LIVING AND DINING SPACE fitted with a stylish kitchen which features INTEGRATED APPLIANCES and ample storage with additional overhead cupboards. The large BAY WINDOW enjoys a front outlook fitted with BESPOKE LOCALLY MADE SHUTTERS creating the perfect dining nook. The double bedroom enjoys a front aspect and there is a LUXURY SHOWER ROOM, along with a large storage cupboard in the hallway. Externally the COMMUNAL PARK LIKE GARDENS are mainly laid to lawn for the residents to enjoy and there is a private enclosed area of garden. At the front of the

GROUND FLOOR 404 sq. ft.
(37.5 sq. m.)

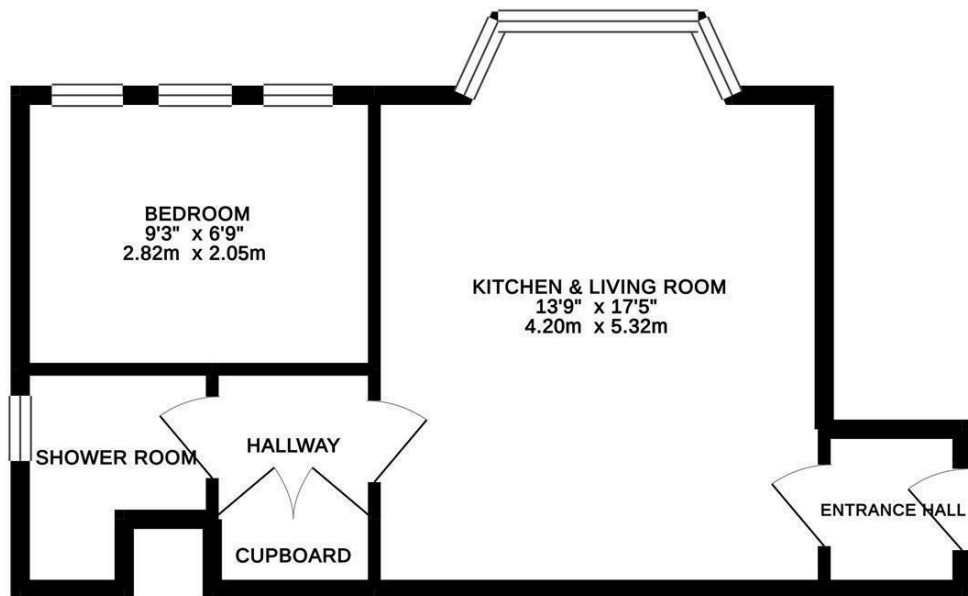

TOTAL FLOOR AREA : 404 sq. ft. (37.5 sq. m.) approx.

Whilst every attempt has been made to ensure the accuracy of the floorplan contained here, measurements of doors, windows, rooms and any other items are approximate and no responsibility is taken for any error, omission or mis-statement. This plan is for illustrative purposes only and should be used as such by any prospective purchaser. The services, systems and appliances shown have not been tested and no guarantee as to their operability or efficiency can be given.
Made with Metropix ©2019

